

Dell Smart-UPS 1,500 - 3,000 VA

120 V

Advanced line interactive power protection
for servers and network equipment



Reliable. Intelligent. Efficient. Manageable.

Engineered by APC™ by Schneider Electric™, the Dell Smart-UPS™ is the most popular UPS in the world for servers, storage, and networks. Trusted to protect critical data and equipment from power problems, Smart-UPS units supply clean and reliable network-grade power, and have extremely high efficiency at low, medium, and high load levels — making them ideal for today's multi-core or virtualized servers that have varying load consumption. Available in both tower and rack-mount form factors, there is a model for every application and budget.

Intelligent and efficient network power protection, Smart-UPS is the ideal choice for servers, point-of-sale, routers, switches, hubs, and other network devices.

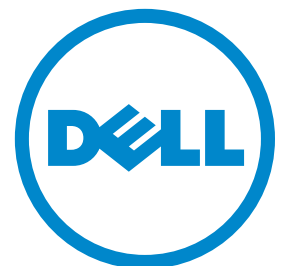

Dell Smart-UPS Tower and Rack-mount 1,500 - 3,000 VA

Application-optimized standard models, ideal for servers, storage, point-of-sale, and other network devices



[DLT1500]



[DLT1500RM2U]



[DLT1500RM2U]



[DLT1500]

Standard Features

High-efficiency Green Mode:

Optimum efficiency which saves utility and cooling costs

Emergency Power Off (EPO):

Provides for remote UPS shut-off in the event of a fire or other emergency (2,200 VA and above)

Alphanumeric LCD Display:

Intuitive interface providing detailed and accurate information with ability to configure locally

Battery Disconnect:

Convenient way to disconnect battery for transport

Network-grade Power:

Provides most stable power conditions by filtering noise, automatic voltage regulation (AVR), and surge protection

Communication Ports:

Serial, USB, and SmartSlot™ for accessory cards

Advanced Battery Management:

Temperature-compensated charging extending life, and advanced algorithms recommend replacement date

Dell Smart-UPS Display

Intuitive, easy-to-use LCD interface

Standard Features

LCD Display Screen

Clear, consistent, and detailed information in your choice of basic or advanced menus

Power Status:

- Operating mode and efficiency
- Load VA/Watts/Amps
- Input/Output voltage and frequency
- Battery capacity and runtime
- Energy meter and more

Control:

UPS and outlet group settings

Configuration:

- Language
- Power quality settings
- Alarm, delay, and threshold settings

Test and Diagnostics:

Initiate battery and runtime calibration tests

Logs:

See explanation of last 10 transfers and faults

About:

UPS and replacement battery part numbers, serial numbers, battery install, and suggested replacement dates

Quick Status Indicators

Online, on battery, fault, and replace battery LEDs for quick status identification

Escape:

Exits to the previous menu or screen

Return:

Used to enter or confirm settings

Navigation Arrows:

Allow for quick adjustment of settings

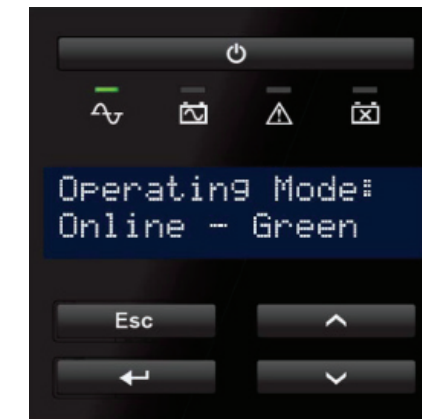

Product Services and Accessories

Dell Smart-UPS warranty and support is provided by APC by Schneider Electric. In addition, APC offers a wide variety of accessories for Dell Smart-UPS, including the items listed below:

Management Cards

AP9630: UPS Network Management Card

AP9631: UPS Network Management Card with Environmental Monitoring

AP9620: Legacy Communications SmartSlot Card

Additional Accessories

AP9625: APC Smart-UPS Two-post Rail Kit

SMX039-2: APC Smart-UPS 48 V Battery Extension Cable

SMX040: APC Smart-UPS 120 V Battery Extension Cable

Service Bypass Panels

SBP1500RM: APC Service Bypass PDU, 120 V; 15 AMP w/ (8) NEMA® 5-15R
SBP3000RM: APC Service Bypass PDU, 120 V; 30 AMP w/ (4) NEMA 5-20R and (1) L5-30R

SBP3000: APC Service Bypass Panel, 100 – 240 V; 30 A; BBM; Hardwire Input/Output

SBP3000RMHW: APC Service Bypass Panel, 100 – 240 V; 30 A; BBM; Hardwire Input/Output



AP9631



SBP3000RM



UPS Model	DLT1500	DLT2200	DLT1500RM2U	DLT3000RM2U
Output				
Power capacity	1,000 W/1,440 VA	1,920 W/2,200 VA	1,000 W/1,440 VA	2,700 W/3,000 VA
Nominal output voltage	120 V			
Output frequency	57 - 63 Hz			
Waveform type	Sine wave			
Switched outlet groups	(8) 5-15R		(6) 5-15R	(6) 5-15R, (2) 5-20R
Input				
Nominal input voltage	120 V			
Input voltage range for main operations (Max adjustable range)	82 - 144 V (75 - 154 V)			
Input frequency	50/60 Hz +/- 3 Hz (auto sensing)			
Input connection	5-15P, 6-ft. cord	5-20P, 6-ft. cord	5-15P, 8-ft. cord	L5-30P, 8-ft. cord
Batteries and runtime				
Battery type	Maintenance-free sealed lead-acid battery with suspended electrolyte; leak proof			
Replacement battery	RBC7	RBC55	APCRBC133	RBC43
Runtime estimates (h:mm)				
200 W	1:24	2:17	:27	1:26
500 W	:23	:51	:12	:38
700 W	:12	:34	:07	:26
1,000 W	:07	:21	:04	:17
1,400 W		:13		:11
1,600 W		:10		:09
Full load	:07	:07	:04	:03
Communication and management				
Interface ports	Serial (RJ45), USB, and SmartSlot			
Control panel and audible alarms	Alpha-numeric LCD display with LED status indicators; alarm on battery, distinctive low battery alarm and configurable delays			
Emergency power off (EPO)	Optional	Yes	Optional	Yes
Surge protection and filtering				
Surge energy rating	480 J		459 J	480 J
Filtering meets	Full-time multi-pole noise filtering; 0.3% IEEE surge let-through, zero clamping response time, meets UL® 1449			
Physical				
Maximum height (in.)	8.5	17.0	3.5	3.5
Maximum width (in.)	6.7	7.7	17.0	19.0
Maximum depth (in.)	17.3	21.5	18.0	26.0
Net weight (lb.)	53	112	63.0	96.0
Conformance				
Regulatory	UL 1778, CSA®			
Energy Star Compliance	Pending			
Warranty	3 years: UPS and battery			

Dell Smart-UPS On-Line 3,000 - 8,000 VA

120/208 V

High-density, double-conversion online power protection with scalable runtime



A versatile UPS developed for the harshest power conditions in the world

Dell Smart-UPS On-Line provides high-density, true double-conversion online power protection for servers, voice/data networks, medical labs, and light industrial applications. When business-critical systems require runtime in hours, not minutes, Smart-UPS On-Line can be configured with matching battery packs to comply with aggressive runtime demands. The included PowerChute™ management software provides unattended graceful shutdown of network operating systems.

All models 5 kVA and above include an integrated network management card for remote management (optional on models below 5 kVA). The entire Smart-UPS On-Line family provides value to customers with demanding power environments, including very wide input-voltage window, extremely tight output-voltage regulation, frequency regulation, internal bypass, and input power factor correction.

Dell Smart-UPS On-Line ship as towers, with the rail mounting kit included in the box for quick rack-mount conversion.

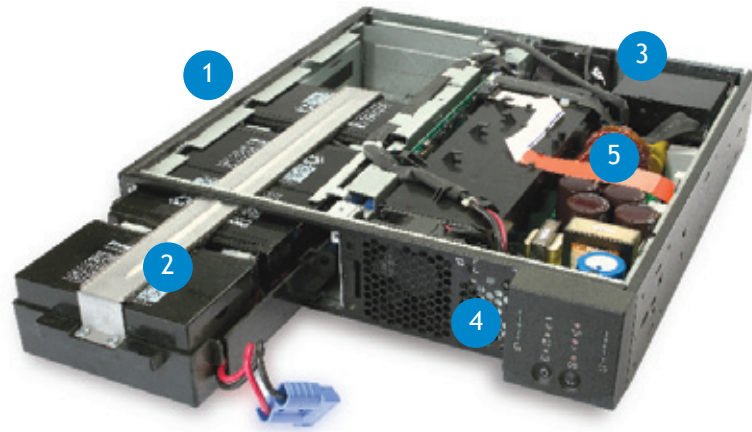

- 1 Rack/Tower Convertible**
Ensures integration in various environments
- 2 Hot-swap/User-replaceable Batteries**
Ensures continuous operation of the load even when the batteries are being replaced
- 3 Double Conversion Online**
Provides tight voltage and frequency regulation, and zero transfer time for reactive loads (machinery, lab equipment, etc.)
- 4 Advanced 16-Segment LED Display**
Provides unit and power status at a glance
- 5 Frequency and Voltage Regulation**
Gives higher application availability by correcting poor frequency and voltage conditions without using the battery

Management Cards

- AP9613: Relay I/O SmartSlot™ Card
- AP9622: Modbus/Jbus Interface Card
- AP9630: UPS Network Management Card
- AP9631: UPS Network Management Card with Environmental Monitoring
- AP9810: APC Dry Contact I/O Accessory

Transformers

- AP9626: APC Step-Down Transformer RM 2U 208 V IN 120 V OUT; with 5-20 Receptacles
- AP9627: APC Step-Down Transformer RM 2U 208 V IN 120 V OUT; with L5-20 Receptacles
- SURT003: APC Smart-UPS RT Tower Isolation/ Step-Down Transformer 5,000 VA 208/120 V

Backplate Kits

- SURT007: APC Smart-UPS RT 3/5/6 kVA Input/ Output Hardwire Kit
- SURT009: APC Smart-UPS RT 3,000 VA, 100-120 VAC, Output Hardwire Kit
- SURT011: APC Smart-UPS RT 208 V 3,000/5,000 VA Backplate Kit with (2) 6-20R and (1) L6-30R
- SURT012: APC Smart-UPS RT 208V 7.5/10 kVA Backplate Kit with (2) 6-20R and (2) L6-30R
- SURT014: APC Smart-UPS RT 5/6 kVA 120 V PDU KIT with (6) NEMA 5-20
- SURT015: APC Smart-UPS RT 5/6 kVA 208 V PDU KIT with (3) NEMA L6-20
- SURT016: APC Smart-UPS RT 5/6 kVA 120/208 V PDU KIT with (1) L14-30 and (2) L5-20
- SURT017: APC Smart-UPS RT 5/6 kVA 208 V PDU KIT with (2) L6-30
- SURT018: APC Smart-UPS RT 5/6 kVA Input/Output Hardwire Kit
- SYPD3: APC Symmetra™ RM and LX 208/240 V Backplate Kit with (2) L6-20R and (1) L6-30R
- SYPD7: APC Symmetra RM and LX 208/240 V Backplate Kit with (3) L6-20R
- SYPD11: APC Symmetra RM and LX 208/240 V Backplate Kit with (2) L6-30R

Other

- SURT013: SURT Equipment Cart

Rail Kits

- SURTRK2: APC Smart-UPS RT 19" Rail Kit for Smart-UPS RT 3/5/6/8/10 kVA

Battery Packs

- DLRT192RMXLBP3U: Dell Smart-UPS RT 192 V RM Battery Pack

Service Bypass Panels

- SBP3000: APC Service Bypass Panel 100 – 240 V; 30 A; BBM; Hardwire Input/Output
- SBP6KRMT2U: APC Service Bypass Panel 200/208/240 V; 50 A; MBB; L6-30P/HW Input; (1) L6-30R (2) L6-20R Output
- SBP10KRMT4U: APC Service Bypass Panel 200/208/240 V; 100 A; MBB; Hardwire Input; (3) L6-30R (3) L6-20R Output

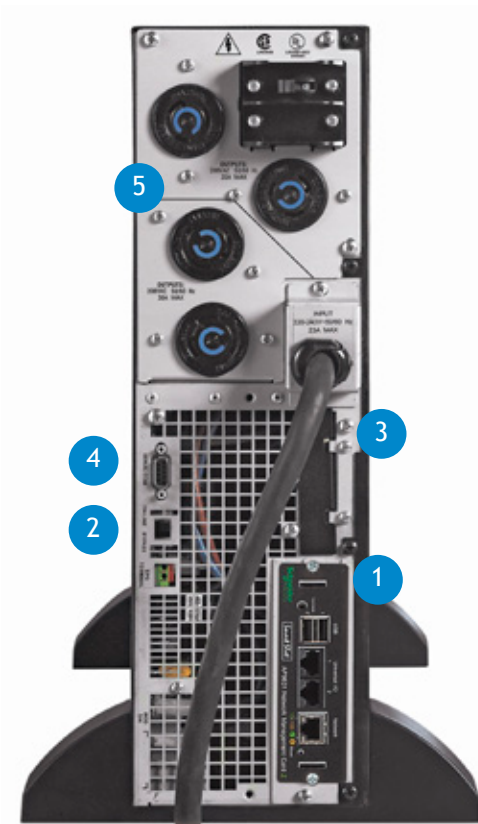

- 1 UPS Network Management Card with Environmental Monitoring**
Provides remote user interface, Manage via Web Browser, SNMP, and Telnet — includes graceful unattended shutdown
- 2 Serial Connectivity**
Enables quick and easy configuration of the UPS
- 3 Scalable Runtime**
Allows additional run time to be quickly added as needed
- 4 Built-in Automatic and Manual Bypass**
Ensures seamless power to the load even in the event of catastrophic UPS failure
- 5 Field-replaceable Power Distribution Panels**
Enables quick in-field modification of output receptacles to fit changing needs

Dell Smart-UPS On-Line Models

UPS Model	DLRTA3000RML3U	DLRTD5000RMLT3U	DLRT8000RMLT6U
Output			
Topology	Double Conversion On-Line		
Nominal Output Voltage	120 V	Configurable for 208 or 240 nominal output voltage	
Efficiency at Full Load	Up to 92%		
Output Frequency (sync to mains)	50/60 Hz +/- 3 Hz user adjustable		
Output Power Capacity	2,100 W	3,500 W	6,400 W
Output Connections	(6) NEMA 5-15R; (2) NEMA 5-20R	(2) NEMA L6-20R; (2) NEMA L6-30R	(1) Hardwire 3-wire (2PH + G); (2) NEMA L6-20R; (2) NEMA L6-30R
Input			
Nominal input voltage	120 V	208 V	
Input Frequency	45-65 Hz (auto sensing)		
Input Connections	L5-30P	L6-30P	Hardwire 3-wire (2PH + G)
Bypass	Automatic and Manual (Built In)		
Battery			
Battery Type	Maintenance-free sealed lead-acid battery with suspended electrolyte; leak proof		
Replacement battery	RBC44		
Runtime	See chart below		
Communication and management			
Interface ports	DB9 Serial and SmartSlot	RJ45 Serial, RJ-45 10/100 Base-T, SmartSlot	DB9 Serial, RJ-45 10/100 Base-T, SmartSlot
Pre-Installed SmartSlot Card	Optional	AP9631	
Control panel and audible alarms	LED status indicators		
Emergency power off (EPO)	Yes		
Physical			
Rack height (in.)	3U		6U
Maximum height (in.)	5.10		10.35
Maximum width (in.)	17.00		17.00
Maximum depth (in.)	26.00		29.00
Net weight (lb.)	120	128	244
Conformance			
Warranty	3 years: UPS and battery		

Runtime Estimates at Half and Full Load (minutes)

UPS Model	DLRTA3000RML3U	DLRTD5000RMLT3U	DLRT8000RMLT6U
Internal	34/14	18/6	20/7
(1) Battery Pack	122/57	70/31	48/21
(2) Battery Pack	217/102	125/58	76/35
(3) Battery Pack	315/150	183/85	106/49
(4) Battery Pack	416/199	242/113	136/63

Due to continuous product improvement programs, all specifications are subject to change without notice. Battery runtimes shown are approximate and may vary with equipment, configuration, battery age, temperature, etc.